

## ROBOPACKER

Volmpack RoboPacker places products into crates and trays using robotic arms at high speed and high accuracy. A vision camera ensures utmost precision in placing the product precisely into the box. The product is handled gently through the entire process and is either moved using vacuum, gripper or a combination tool.



### FEATURES

- Touch screen to control all settings and manage product layout
- Stainless steel or painted mild steel construction
- Up to three trays/crates/boxes filled simultaneously
- Straightforward and efficient integration with existing packing lines
- Fast changeover system with adjustable rails and quick change tool.
- Dimensions, inlet and outlet can be customized with a small footprint

### OPTIONS

- Single, dual or triple robotic pickers
- Multiple robotic choices for weight, speed, accuracy & carton size

### PACKAGE SIZE/WEIGHT

- Min 3/8"L x 3/8"W x 1/8"H Max. 19 3/4"L x 13 7/8"W x 9 1/2"H
- 6 pounds\*

### CASE SIZE

- Min 9 3/4"L x 9 3/4"W x 1 1/3"H Max. 23 3/8"L x 15 3/4"W x 18 1/2"H

### CAPACITY/RATE

- Up to 160 packages per minute\*\*

### AIR CONSUMPTION

- Actual air consumption depends on options chosen

### POWER

- 480 Volt, 3 phase and ground



Top Sealed



Clamshell



Tray



Pillow Pack



Flow Wrapped



Bags

\*Depends on product size and robot type

\*\*The RoboPacker with two robots has a capacity up to 160ppm. Achievable speed depending on the product/packaging material

# ROBOPACKER

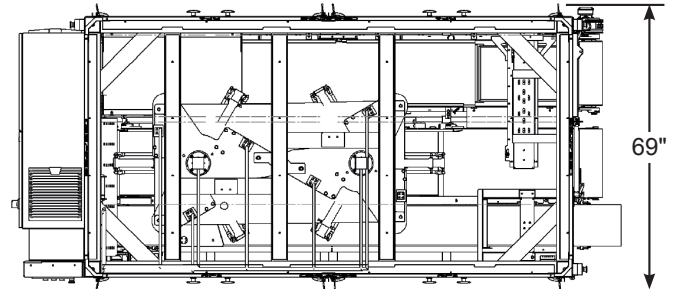
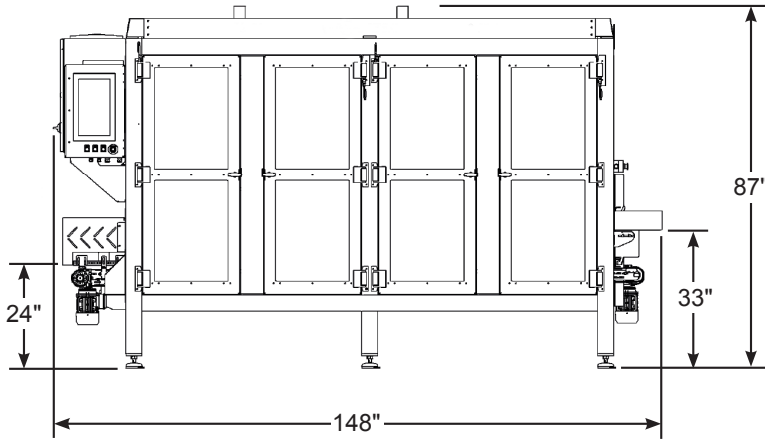

Inlet and outlet can be customized  
Measurements are rounded to the nearest inch

## TRAY & BOX OPTIONS



Die-Cut Tray with Flaps



RPC (Reusable Plastic Container)



Die-Cut Open Tray

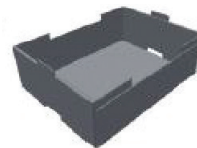

RSC (Regular Slotted Container)



Corrugated Box

## PACKING PATTERNS

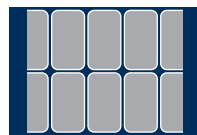
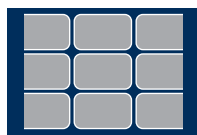
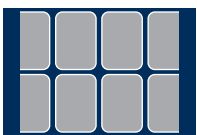
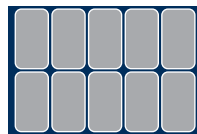
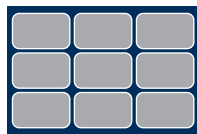
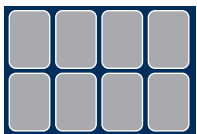

Additional packing patterns available upon request